



# Installation Guide

# Soft Tonneau Cover

**GWM Cannon Alpha Ultra Non Sports Bar**

**Part Number - 11683**

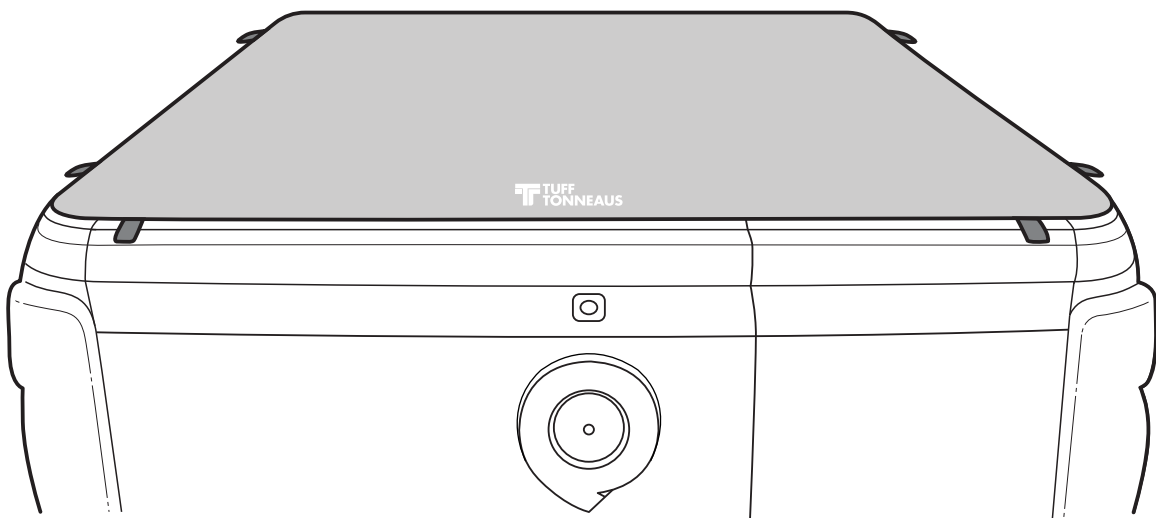

## - PARTS SUPPLIED

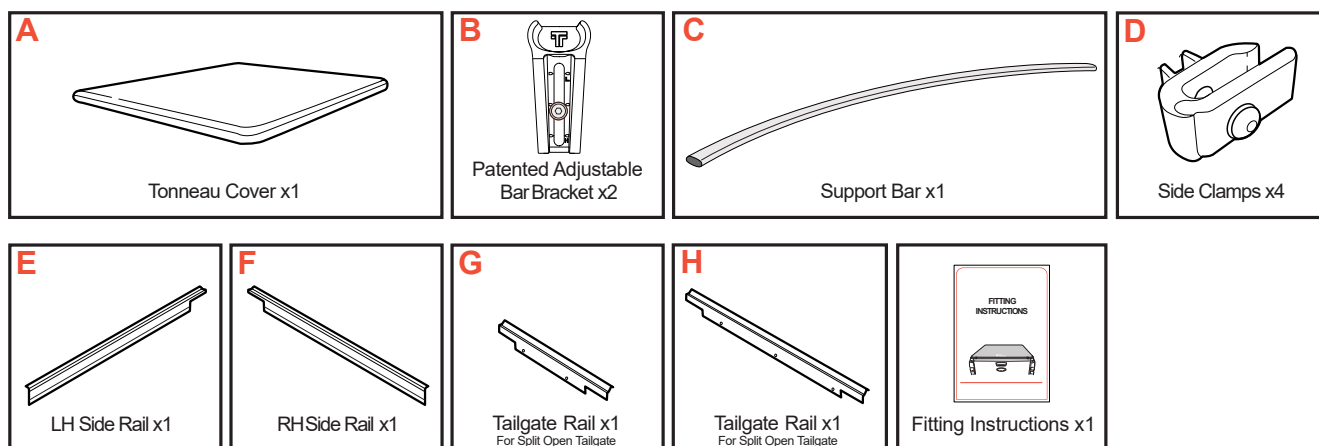

## - SAFETY NOTES

- Ensure that appropriate Personal Protective Equipment is used.
- During the accessory fitment, ensure all Australian automotive and dealership safety practices are followed.
- Always refer to the vehicles workshop manual when removing components.



## - FINAL ASSEMBLY

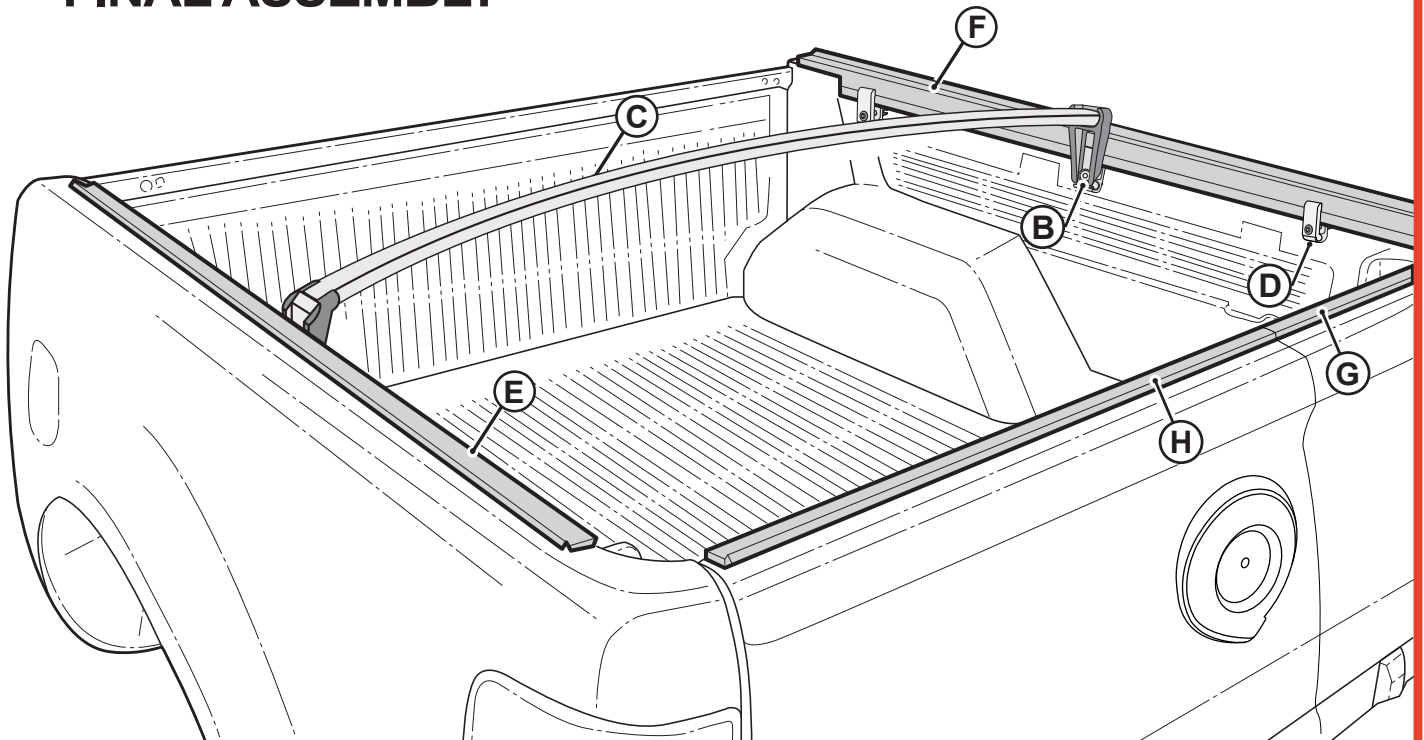

# 1

## ASSEMBLING THE BAR BRACKET

### STEP 1

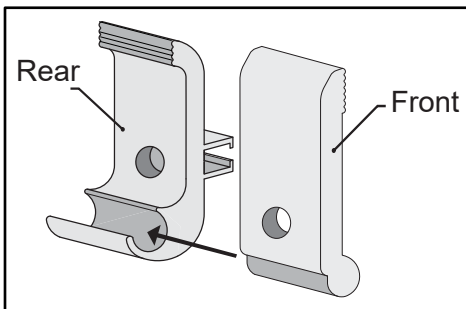

- Slide the Front and Rear Clamps together.

### STEP 2

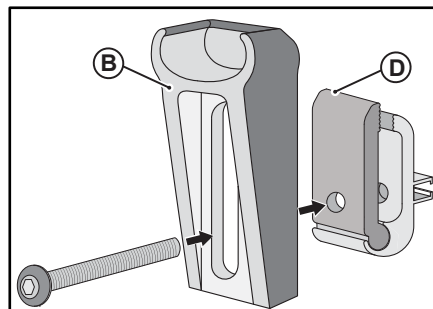

- Attach the Clamp to the Patented Adjustable Bar Bracket as shown.

### STEP 3

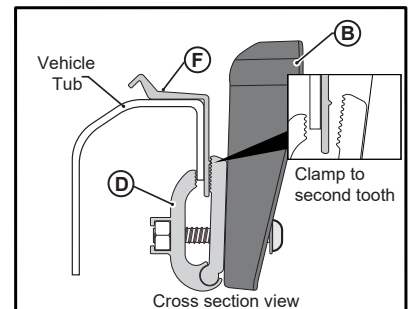

- Engage the now assembled Bar Bracket & Clamp to the Side Rails in the next steps.

### STEP 4

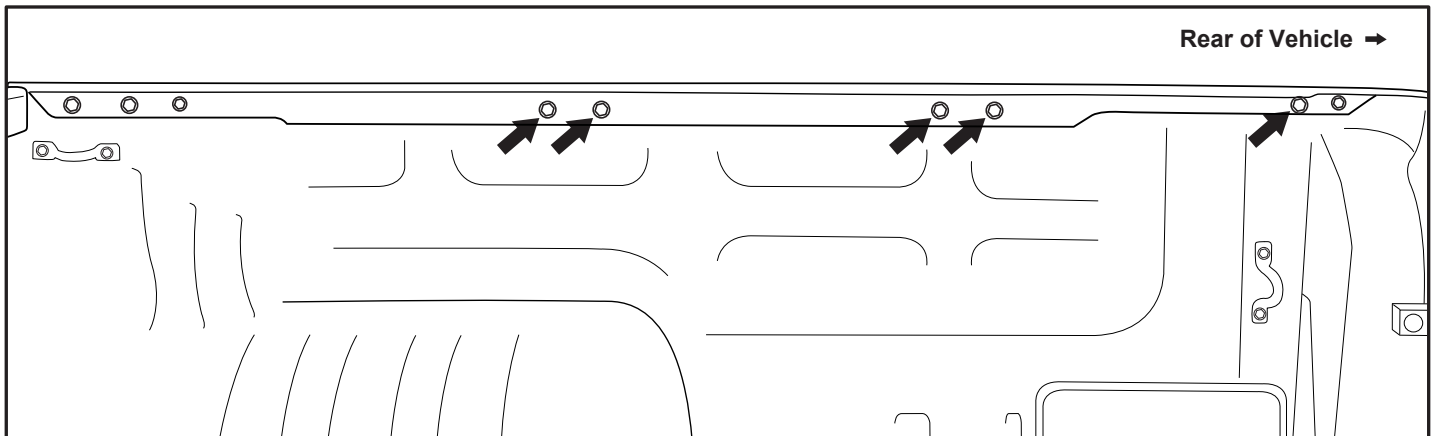

- Remove the 5 screws as shown from both inner sides on the tub, using appropriate tool.

## 2

## ATTACH THE SIDE RAILS

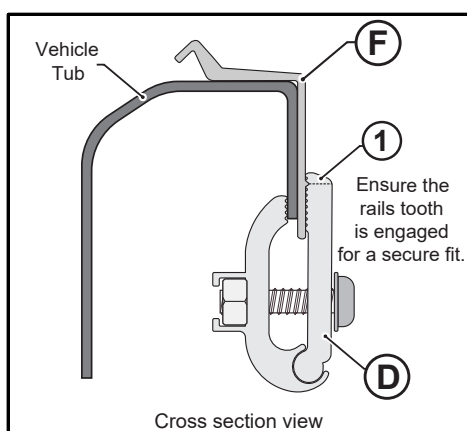
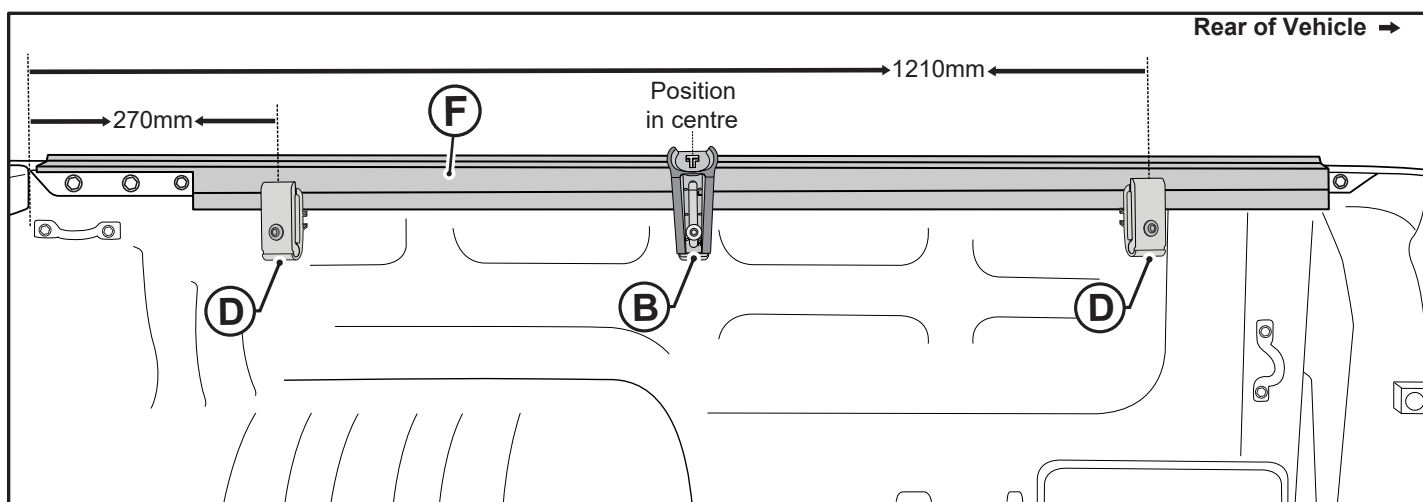

- Place Side Rail (F) in place as shown, followed by placing the bar bracket (B) and (D) clamps, using the dimensions shown above.
- Tighten bracket and clamps in place using appropriate tool.
- Repeat for the LHS with Side Rail (E).

### Important



The side clamp needs to engage with the side aluminium rail tooth for a secure fit.

## 3

## FIT THE SUPPORT BAR

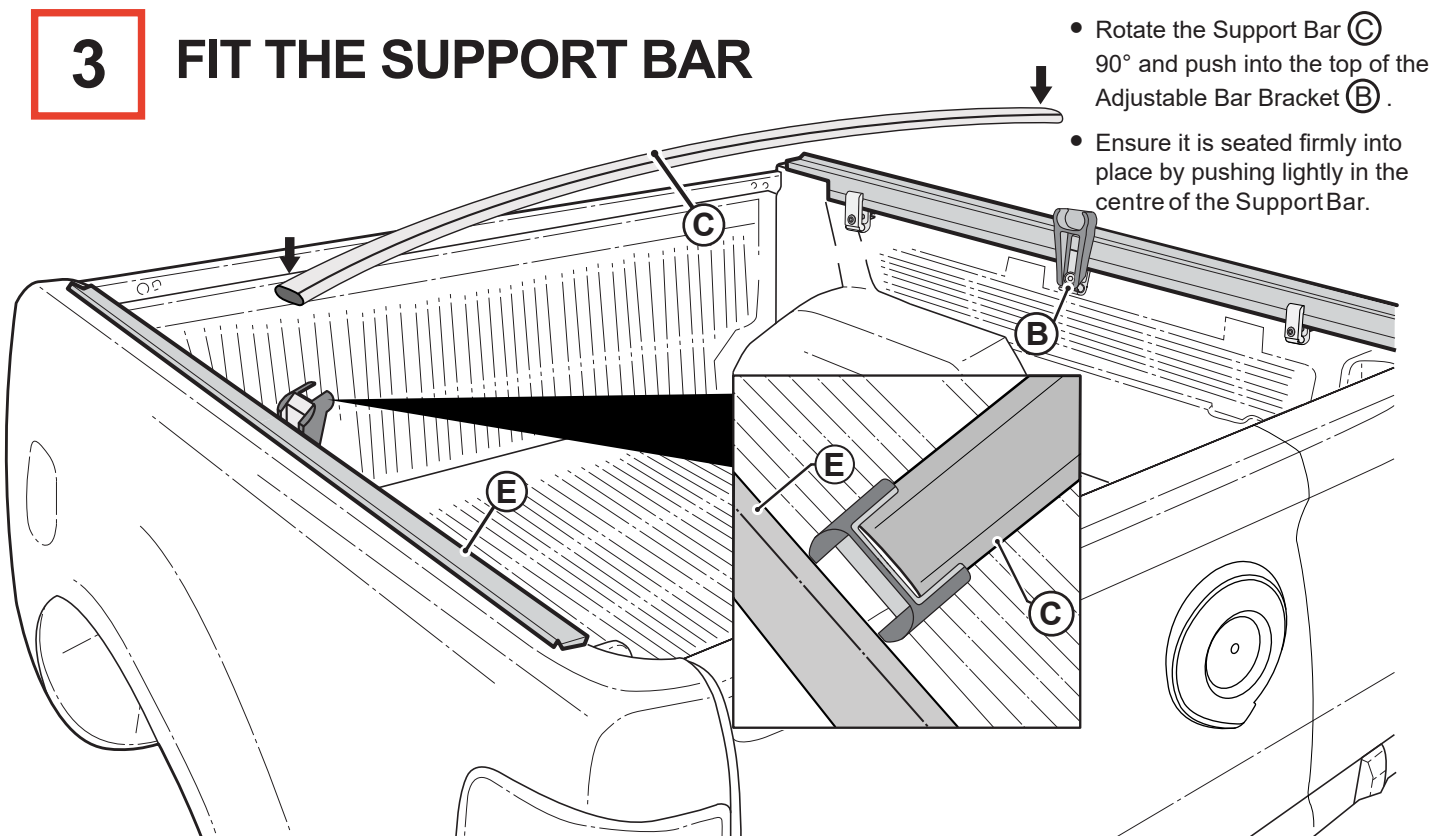

- Rotate the Support Bar (C) 90° and push into the top of the Adjustable Bar Bracket (B).
- Ensure it is seated firmly into place by pushing lightly in the centre of the Support Bar.

# 4

## ATTACH THE TAILGATE RAIL

### STEP 1

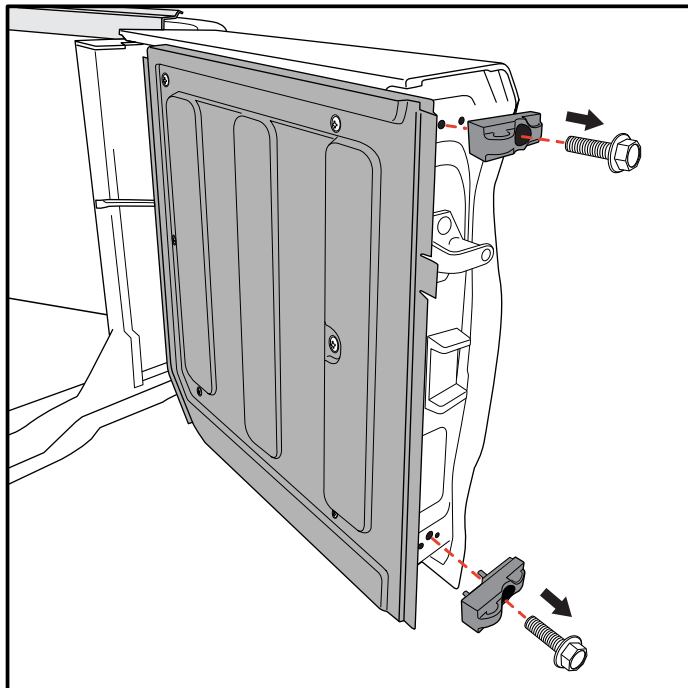
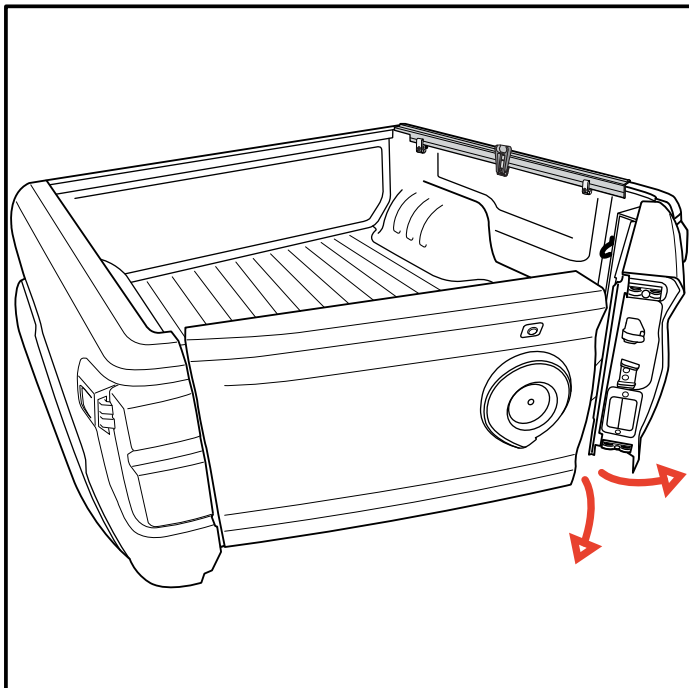

- Open the split tailgate.

- Start with removing the two bump stops as shown with appropriate tool on the narrow half of the tailgate.

### STEP 2

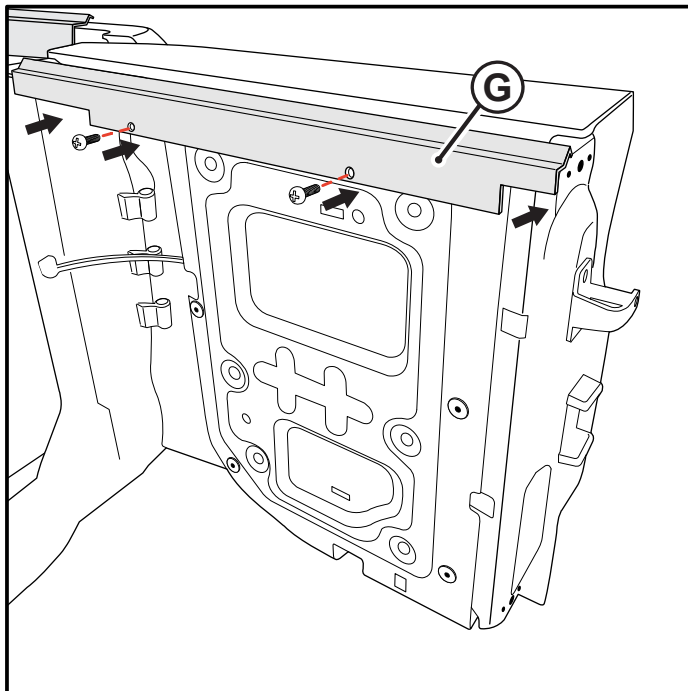
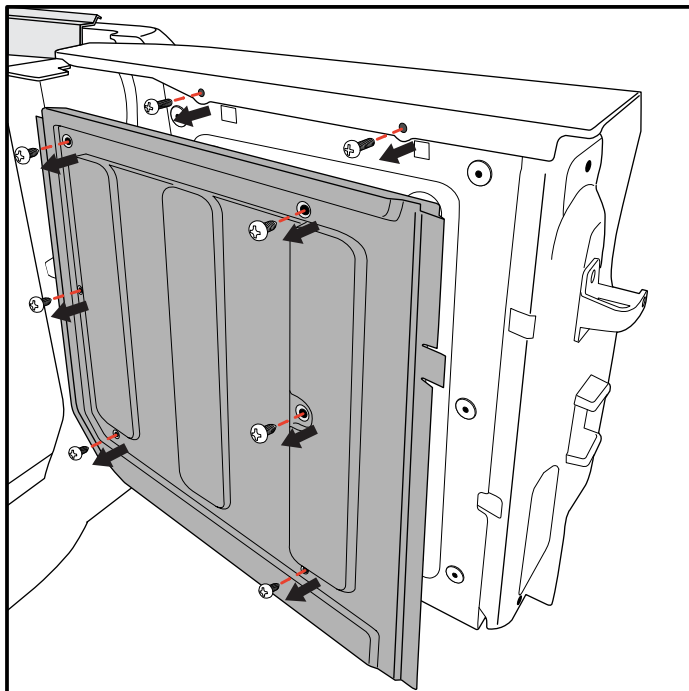

- Remove the 6 screws from the liner panel as shown with appropriate tool. Then remove the 2 inner screws that are along the top of the of tailgate.

- Screw on tailgate rail ① using the 2 factory screws again, along the top of tailgate.

## STEP 4

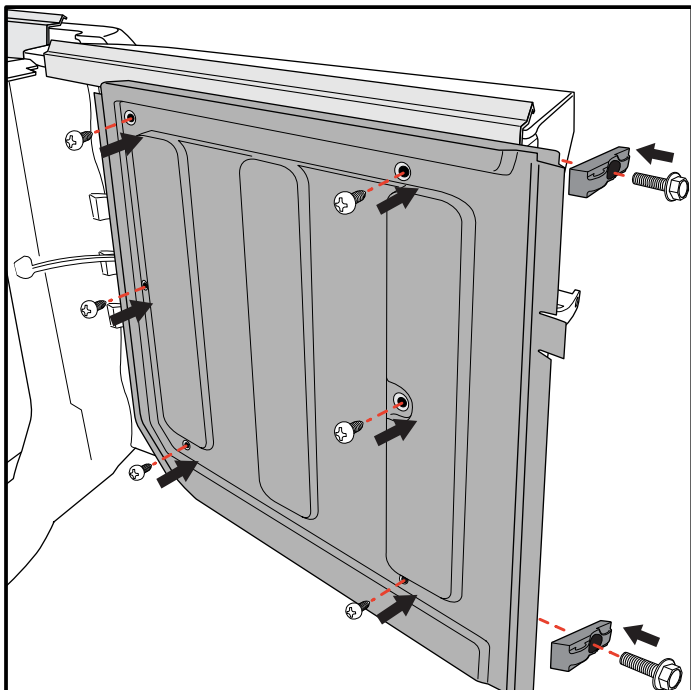

- Screw on the liner panel with the 6 factory screws again. Then screw back the 2 bump stops again as shown.

## STEP 5

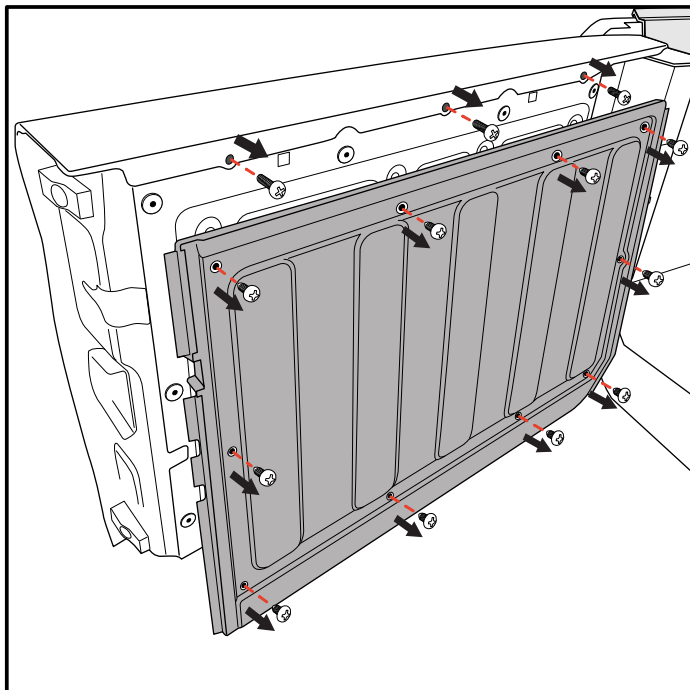

- Remove the 10 screws from the liner panel on the wider half of the tailgate as shown with appropriate tool. Then remove the 3 inner screws that are along the top of the of tailgate.

## STEP 6

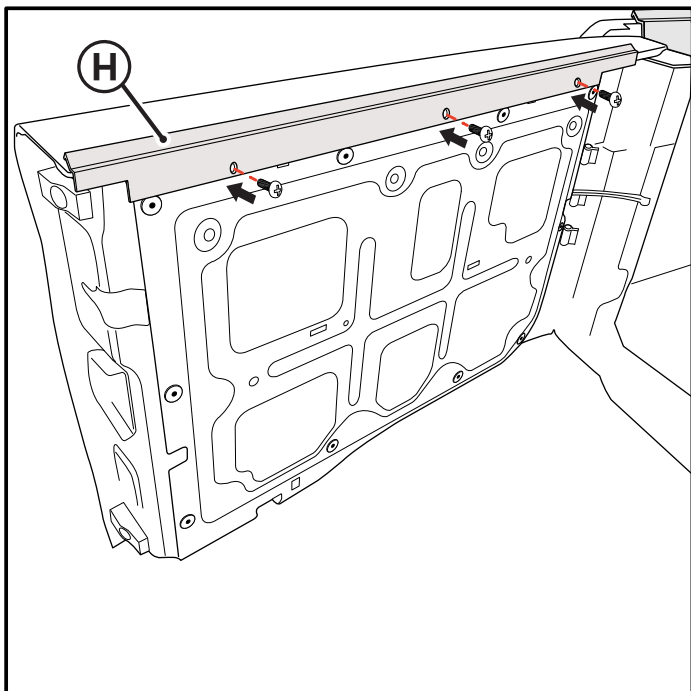

- Screw on tailgate rail (H) using the 3 factory screws again, along the top of the tailgate.

## STEP 7

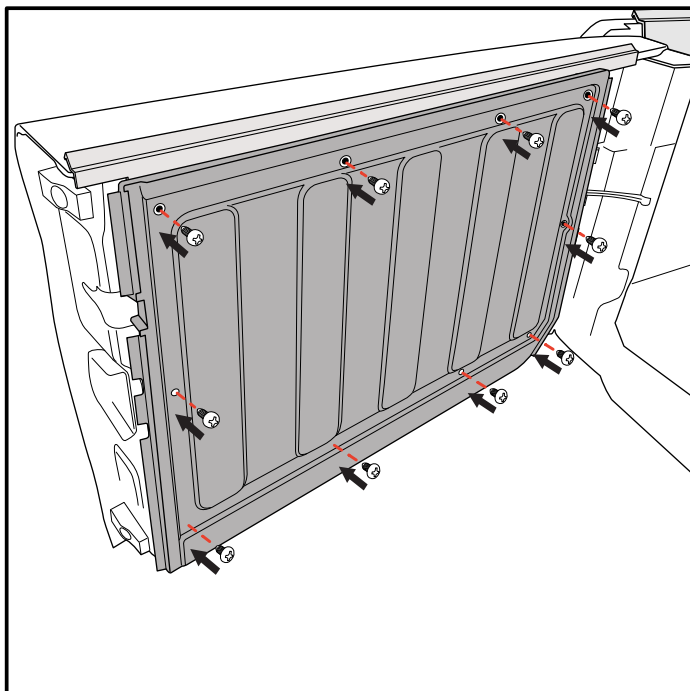

- Screw on the liner panel with the 10 factory screws again.

# 5

## FIT THE TONNEAU COVER

- Start by removing the rubber seal from the top front outer edge of the tub.
- Attach the plastic J Retainer on the front of the Tonneau Cover to the front lip of the Ute tub located behind the cab window.
- Engage the back of the cover first, followed by the sides.

**Note:** Ensure the support bar is fitted underneath the Tonneau Cover to prevent water ingress and to keep the cover tight.



Use the pull tabs to assist whenever you open or close your cover.

**Note:** Fitment will be tight straight out of the box, but this should loosen up a little after a week or so.

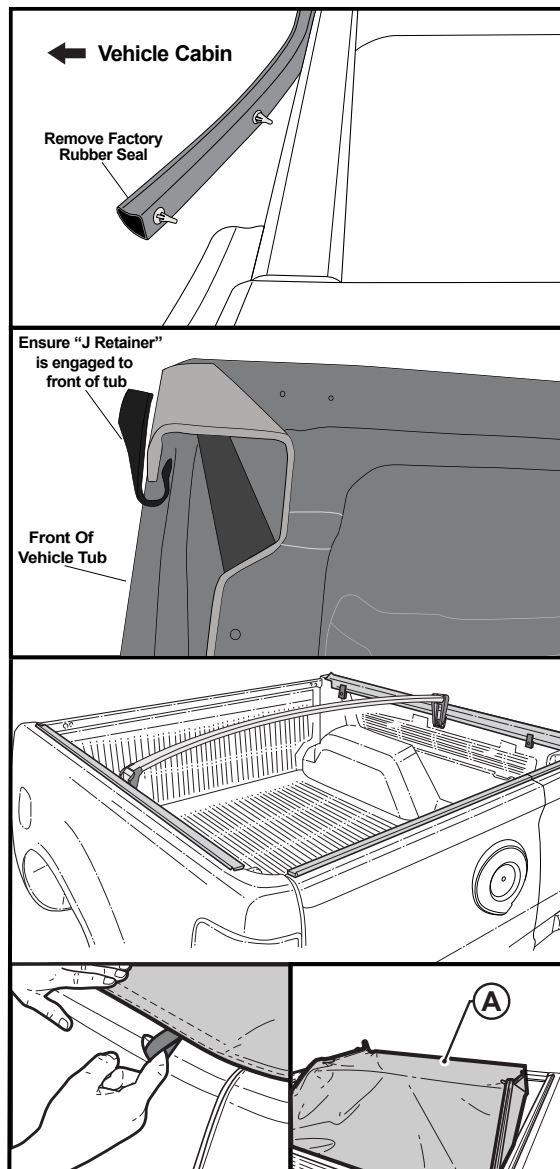

## ADJUSTING THE TENSION OF THE COVER

- To adjust the tension of the cover, you must adjust the height of the support bar. To do this, we have designed a patented adjustable bracket system which will allow you to freely adjust the height to any position within the range of the bracket.
- Simply loosen the bolt which goes through the Bar Bracket and Clamp then move the bracket either up or down until the bolt is at your desired level. Re-tighten the bolt.
- Your Adjustable Bar Bracket has a large tension range.  
 “L” lowers the height and loosens the cover.  
 “H” increases the height and tightens the cover.



“L” set here if cover is tight and hard to clip on.

“H” set here if cover is loose or if water is pooling on it.

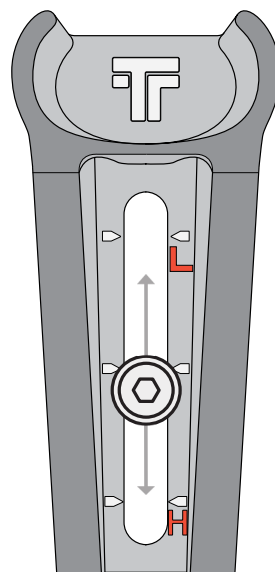



# TONNEAU COVER TETHERING SYSTEM

## STEP 1

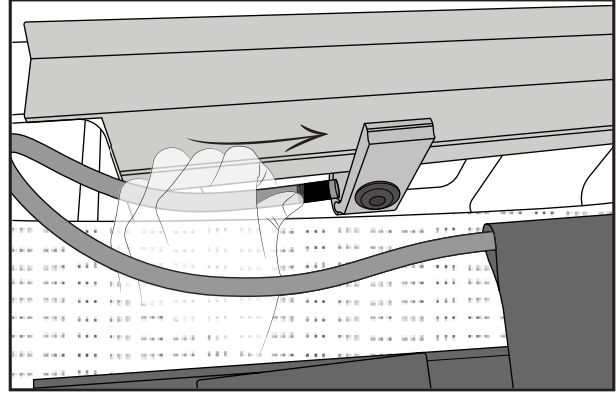
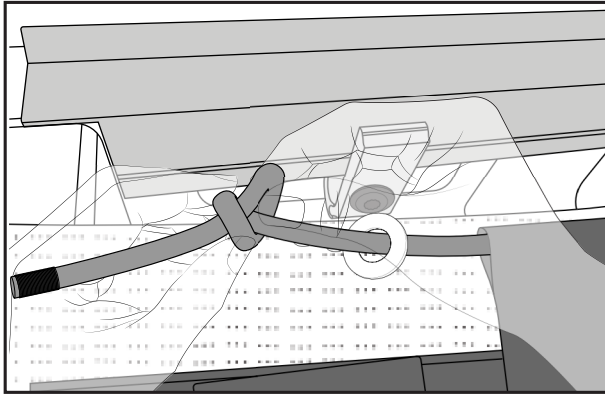

- Unclip the drivers side section of the cover from the aluminium rail.
- Untie the knot and remove the washer.
- Thread the rope through the clamp located near the front of the tub.

## STEP 2

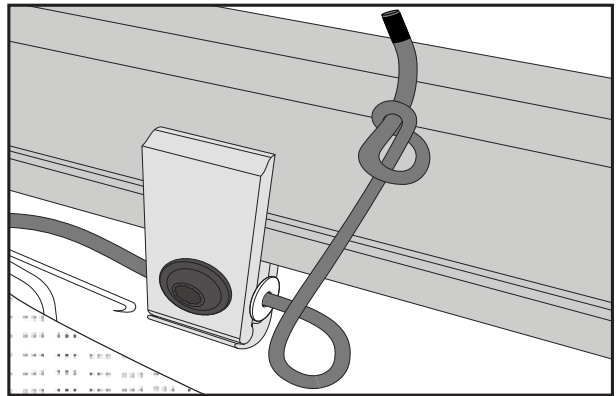
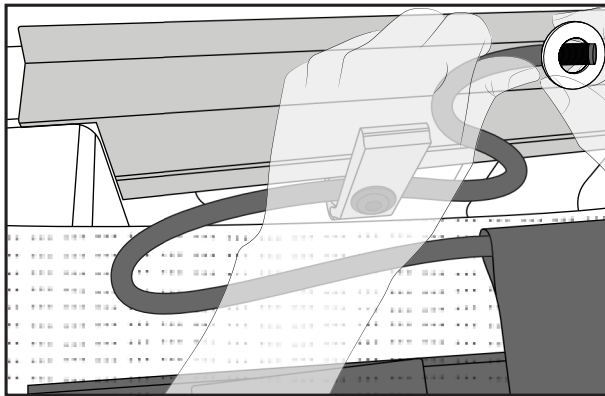

- Rethread the washer and tie the end of the rope in a knot.

## STEP 3

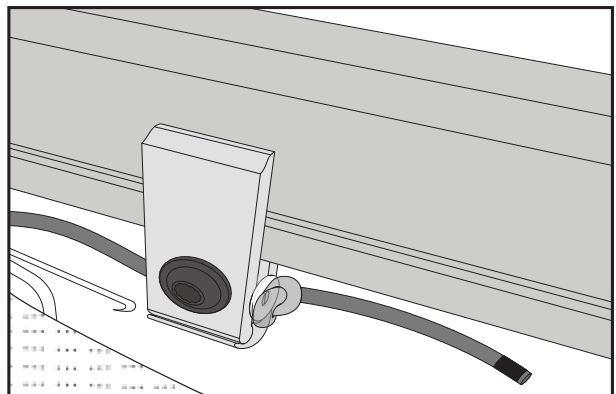
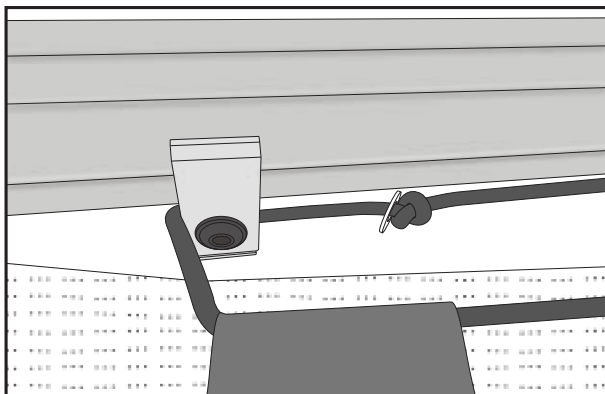

- With the washer in place the rope can not slip past the clamp.
- Repeat these steps for the passenger side.



**This product must be installed exactly as specified in this installation manual. Failure to do so may result in improper fit which can cause structural damage to the product and vehicle as well as serious accidents due to partial or complete loss of the product and void of warranty.**



# HOW TO USE THE OVERSIZED LOAD SYSTEM

## STEP 1

- Place the load into the ute tub then drape the Tonneau Cover over it as shown.

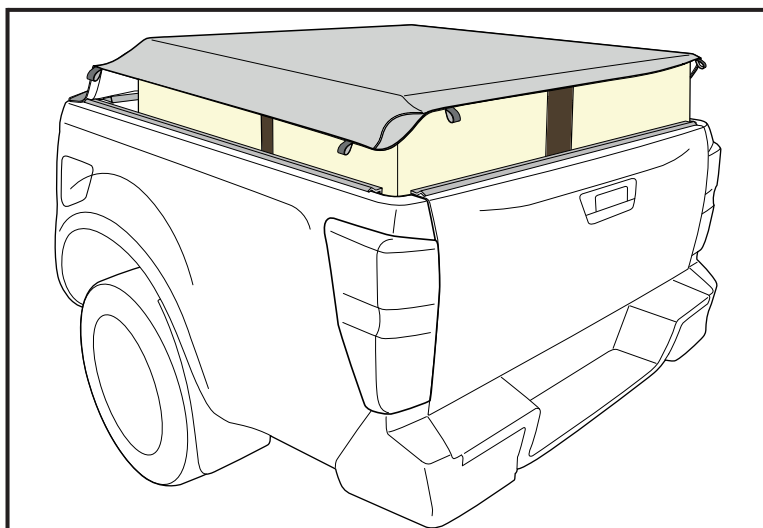

## STEP 2

- Engage the Rope Hooks from underneath the Tonneau Cover and clip each one onto the Aluminium Rails.

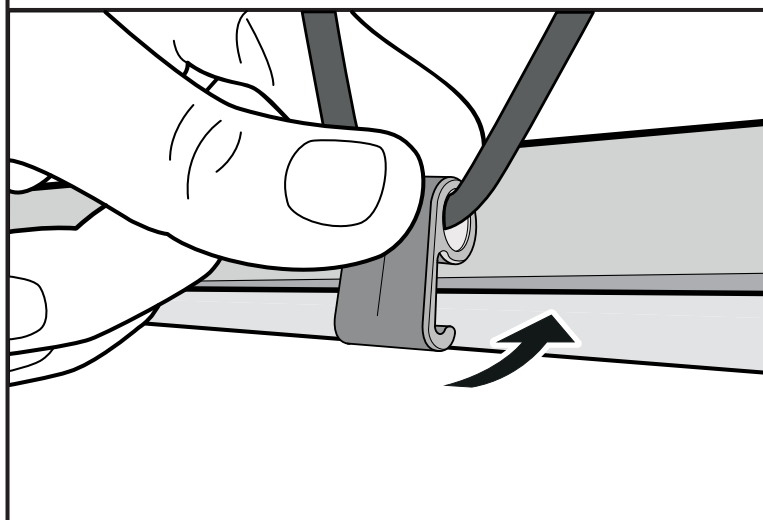

## STEP 3

- Engage all Rope Hooks with even gaps to the side and rear Aluminium Rails for a secure fit.

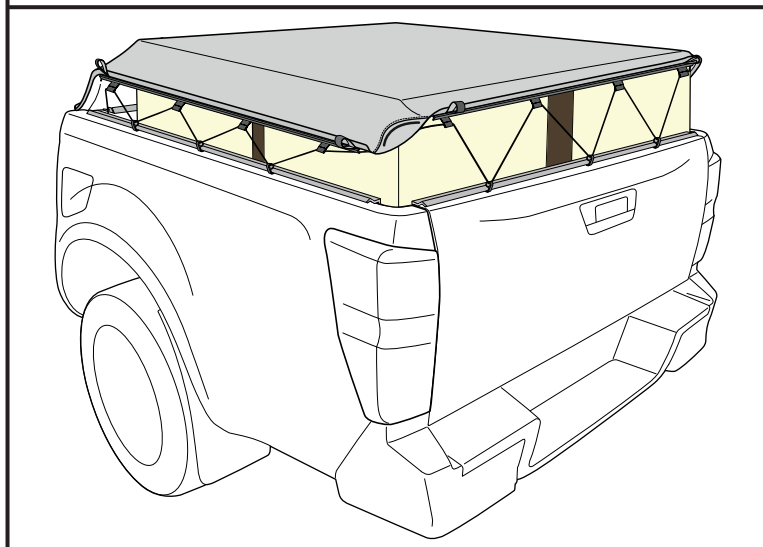

### Important



The Tonneau Cover is not designed to be a load restraint. You **MUST** securely tie down your load first and then use the Oversized Load Cover System.