



TUFF TONNEAUS WHOLESALE PTY LTD ABN 84 064 599 775	TELEPHONE +61 3 8720 0700 FACSIMILE +61 3 9729 8740
2 INDUSTRY PLACE, BAYSWATER 3153 VICTORIA AUSTRALIA	WEBSITE TTO.COM.AU

Tonneau Cover Fitting Instructions

GWM Cannon Vanta With Extended Sport Bars Clip On Tonneau Cover 2020 – Current Part number: 11562

Package includes	
1 x Tonneau Cover	3 x Drill Templates - PVC
1 x Tailgate Centre Rail (760mm)	2 x Bar Bracket
2 x Tailgate Outer Rails (320mm)	1 x Metal Lock Bracket
2 x Rear Side Rails	26 x 4 mm Rivet
2 x Front Side Rails	1 x Inhibitor
1 x Support Bar	1 x Fitting instructions
1 x Support Bar Cover - PVC Sheath	

1. TONNEAU COVER FITTING

NOTE Read entire instructions prior to start. Apply rust inhibitor to all drilled holes prior to riveting.

1.1 BASIC TOOL REQUIRED

Drill, 4mm Drill Bit, Rivet Gun, Marking Pencil / Pen

1.2 TONNEAU COVER INSTALLATION PROCEDURE

Fit Side Rails

1. Clean the top surface of the tub sides with a damp rag and allow to dry. Remove the red backing tape from the underside of one of the Side Rails.

2. Position the side rails centrally between the sports bars and the smaller rail behind the rear sports bar. Slide the rail down keeping the taped surface square with the top of the tub and the vertical face of the aluminium square with the inside edge of the tub until the tape contacts the top face of the tub. *See Figure 1*

3. Press down firmly to ensure adhesion.

4. Position the side templates along the bottom edge and the front edge of the side rails, mark the locations onto the side rails with the Non-permanent marking pen.

See Figure 2

5. Drill each of the marked locations through the aluminium and into the inside edge of the tub.

6. Attach the bar bracket by placing a 4mm rivet through each hole of the bracket and into the holes in the centre of the rail. Rivet into place. *See Figure 3*

7. Rivet the rest of the holes to complete attachment of side rails.

8. Repeat those steps for the opposite side of vehicle.

Fit Tailgate Rails

9. Clean the top surface of the tailgate with a damp rag and allow to dry.

10. Mark & drill two 320mm tailgate pieces 50mm in from each edge, 30mm up from the top edge of the rail using a 4mm drill bit. *See Figure 3*

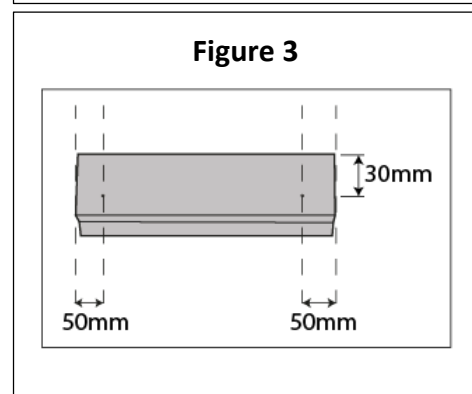
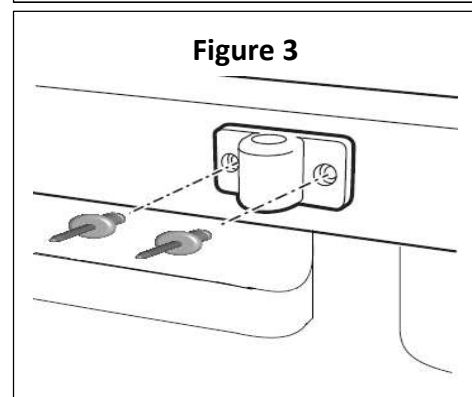
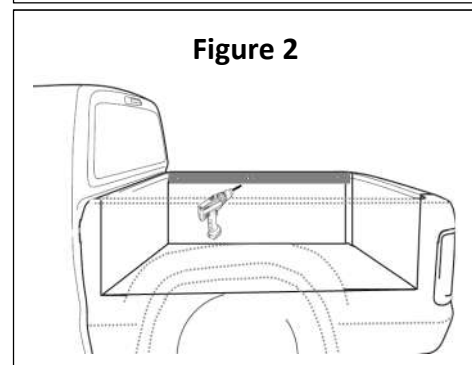
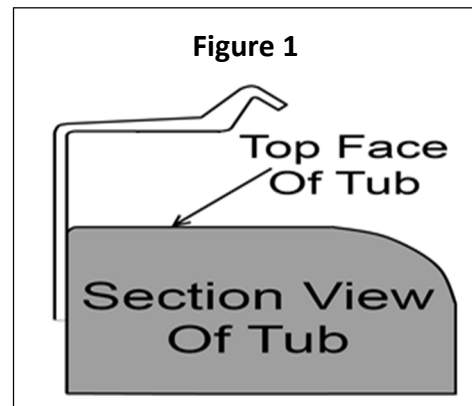

11. Position the 3 tailgate pieces on the tailgate *see Figure 4*. Drill through all the holes on the 3 pieces into the tailgate using a 4mm drill bit. Remove the red tape on the underside of the 3 lengths.

12. Press down firmly to ensure adhesion on each length. Then Apply rust inhibitor and rivet the 3 lengths of tailgate rail to the tailgate to complete the attachment.. *See Figure 4 & 5*

13. Fit the adjustable support bar, refer to Section 3.

14. To attach the cover, fit the front of the tonneau cover to the front of the ute tub by placing the plastic retainer (located under the front of the tonneau cover) on the metal lip of the body of the vehicle, between the cabin and the tub. Rubber seal must be removed from front of vehicle tub.

15. Pull the cover under the sports bar and drape the cover across the tub.

16. Clip the tailgate under the tailgate rail first using the pull loops in the corners to stretch the cover.

17. Clip the plastic on the tailgate under the side plastics under the side rails last. *See Figure 6*

Figure 4

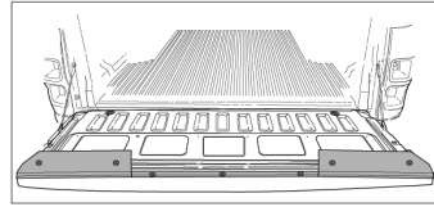

Figure 5

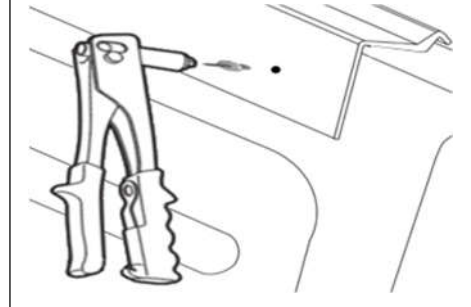
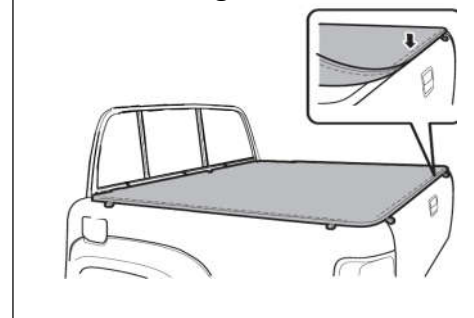

Figure 6



Using Internal Elastic Shock Cord:

The plastic clips on the internal shock cord can be hooked into the aluminium rails so that the cover can still be secured with larger loads in the tub.

NOTE: You can adjust your tonneau, to make it tighter or looser, by simply raising or lowering the height of your tonneau support bar.

2. TONNO LOCK

The Tonno Lock is now a standard feature included with all Tuff Tonneaus. The Tonno Lock is situated at the front of the tonneau cover, so as not to impede the accessibility of the Tuff Tonneau.

Fitting the lock is simple and only requires a small attachment on the inside edge of the tub behind the cab.

Together with a padlock, it provides you with an extremely effective theft deterrent. The Tonno Lock is designed to suit

all utes and prevent thieves stealing your Tuff Tonneau, so you can continue to rely on the Tuff Tonneaus' name to give you what you want in a tonneau cover.



2.1 BASIC TOOL REQUIRED

Rivet gun, Drill, Torch, and Marking Pencil/Pen.

You will need to buy a small Padlock- make sure the padlock will go through the hole on the Tonno lock.

2.2 TONNO LOCK CONTENTS

- 2 X 4MM Aluminium rivets
- 1 x Tonno Lock bracket

2.3 FITTING TONNO LOCK

1. Attach the black lock bracket to the bracket on the tonneau with your padlock, and fit the tarp.
2. Getting under the tarp with a torch, place the lock bracket against the body and mark holes with a pen.
3. Remove tonneau and drill the marks with a 4 mm drill bit, place the lock bracket in position and rivet.

3. MULTI-FIT SUPPORT BAR

The Tuff Tonneau Multi - Fit Support Bar is designed to fit almost all Utes on the Market, from Subaru, Brumby's, to Cab Chassis and aluminium trays.



3.1 BASIC TOOL REQUIRED

Drill, 4mm drill bit

3.2 MULTI-FIT SUPPORT BAR CONTENTS

- 1 x hollow bar centrepiece
- 2 x grub screws
- 2 x solid bar end piece
- 1 x Tonneau bar sheath

3.3 FITTING MULTI-FIT BAR

1. Insert solid bar pieces into either end of hollow tube. Adjust bar so it fits between bar bracket holders with the holes facing to the ground (so the grub screws don't rub against the tonneau), as shown above and then with a white pencil make a mark through the small holes of the hollow bar onto the solid ends. This is where you will drill a hole to the depth of about 1-2mm (do not go any further)
2. Join the pieces back together and screw grub screws through the hollow bar into the holes that you drilled. **Make sure you do not over tighten the grub screws**. Then place the tonneau sheath over the bar to stop the bar wearing against the tonneau. Refit the bar. You may kink the bar in the middle to give it some extra height to assist with water runoff.

Warning if you do not fit the tonneau sheath over the bar, the tonneau cover will quickly wear through which is not covered by warranty.

4. WARRANTY AND FEEDBACK

Please register your warranty details online at:

QR Code:



Website Link:

<https://www.tto.com.au/en-au/warranty.html>

Please complete our 2 minute feedback section as we strive to constantly improve for our customers.

Your tuff tonneau is now ready for work.