

1. TONNEAU COVER FITTING

NOTE Read entire instructions prior to start.

1.1 BASIC TOOL REQUIRED

Drill, 4.5mm Drill Bit, Rivet Gun, Marking Pencil / Pen

1.2 TONNEAU COVER INSTALLATION PROCEDURE

1. Using two pieces of dowel join the 3 aluminium rope tracks together. Place the other 2 pieces of dowel in the ends of the now joined rope track. **See Figure 1**

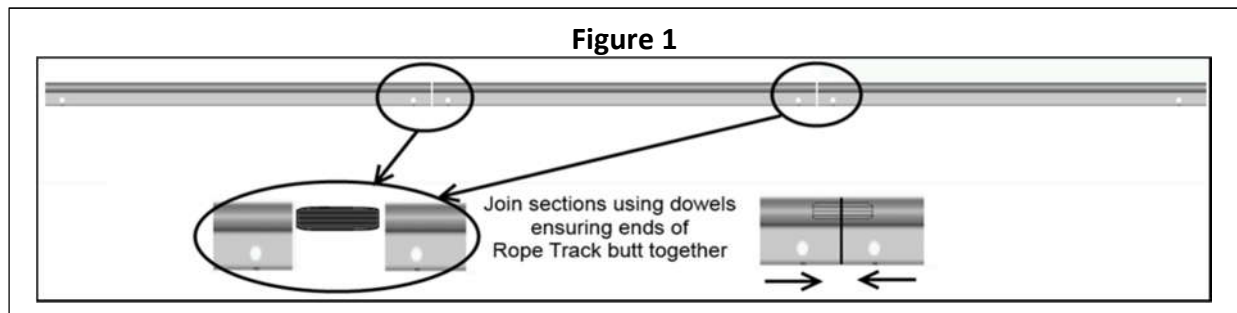

2. Rest the aluminium rope track on the side rails as Shown in **Figure 2**, and push forward to the vertical face of the tub (2).
3. Using a 4.5 mm drill bit, drill 6 holes 50mm from the end of each of the aluminium rope tracks into the front of tub.
4. Once all the holes have been drilled, remove the dowelling pieces. Squeeze silicon along the back of the rope tracks and pop rivet into place.

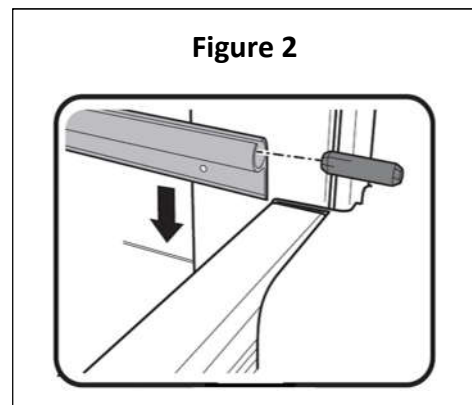

5. To fit bar brackets measure 800 mm from the inside edge at the front of the tub and place them as shown in Figure 2 (5mm down from top edge of tub). Drill and rivet, using 4 rivets. Install bar according to supplied instructions.

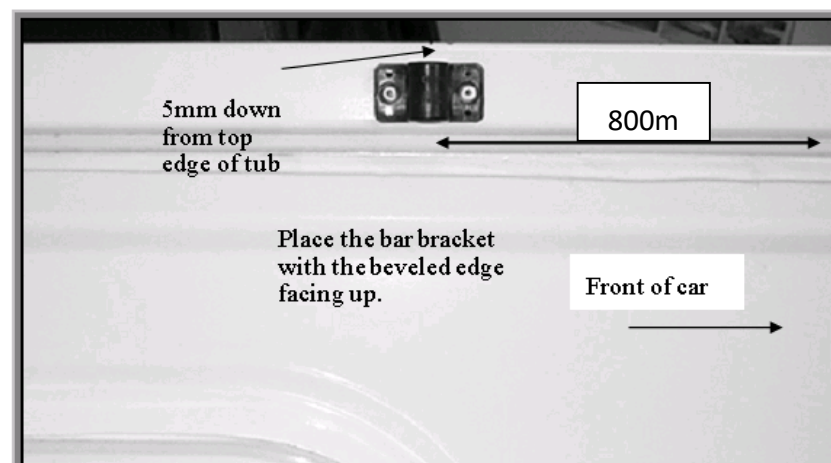

Figure 2: Placement of bar bracket

6. Fit Round Body Hooks (Buttons) to Tailgate

Slide the front of the Tonneau cover through the aluminium rope track section. Neatly spread the Tonneau cover over the support bar so it is centred.

Ensure the Tonneau cover is **centred** and **taut (this is critical)**. Vertically line up each rope button individually to each bunji and starting with the centre two bunjis squeeze the centre bunji loop together and with a non-permanent marker mark 15mm below the squeezed bunji, in this position drill and rivet the button.

Repeat this alternating left and right until all bunjis are attached to buttons on the tailgate.

7. Fit Round Body Hooks (Buttons) to the Sides

Secure the tonneau cover to the buttons on the tailgate. Vertically line up each rope button individually to each bunji starting with both rear corners. Using the same method as the tailgate buttons rivet buttons into the sides alternating from one side of the vehicle to the other and back to front. Secure the Tonneau cover to the vehicle's sides as the rope buttons are fitted.

8. To Fit Anti-Abrasive Discs: Firstly clean the area behind each bunji head with a clean rag and methylated sprits. Then attach the anti-abrasive discs centrally behind each bunji head.

2. TONNO LOCK

The Tonno Lock is now a standard feature included with all Tuff Tonneaus. The Tonno Lock is situated at the front of the tonneau cover, so as not to impede the accessibility of the Tuff Tonneau.

Fitting the lock is simple and only requires a small attachment on the inside edge of the tub behind the cab. Together with a padlock, it provides you with an extremely effective theft deterrent. The Tonno Lock is designed to suit all utes and prevent thieves stealing your Tuff Tonneau, so



you can continue to rely on the Tuff Tonneaus' name to give you what you want in a tonneau cover.

2.1 BASIC TOOL REQUIRED

Rivet gun, Drill, Torch, and Marking Pencil/Pen.

You will need to buy a small Padlock- make sure the padlock will go through the hole on the Tonno lock.

2.2 TONNO LOCK CONTENTS

- 2 X 4MM Aluminium rivets
- 1 x Tonno Lock bracket

2.3 FITTING TONNO LOCK

1. Attach the black lock bracket to the bracket on the tonneau with your padlock, and fit the tarp.
2. Getting under the tarp with a torch, place the lock bracket against the body and mark holes with a pen.
3. Remove tonneau and drill the marks with a 4 mm drill bit, place the lock bracket in position and rivet.

3. MULTI-FIT SUPPORT BAR

The Tuff Tonneau Multi - Fit Support Bar is designed to fit almost all Utes on the Market, from Suburu Brumbys to Cab Chassis aluminium trays.



3.1 BASIC TOOL REQUIRED

Drill, 4mm drill bit

3.2 MULTI-FIT SUPPORT BAR CONTENTS

- 1 x hollow bar centrepiece
- 2 x grub screws
- 2 x solid bar end piece
- 1 x Tonneau bar sheath

3.3 FITTING MULTI-FIT BAR

1. Insert solid bar pieces into either end of hollow tube. Adjust bar so it fits between bar bracket holders with the holes facing to the ground (so the grub screws don't rub against the tonneau), as shown above and then with a white pencil make a mark through the small holes of the hollow bar onto the solid ends. This is where you will drill a hole to the depth of about 1-2mm (do not go any further)
2. Join the pieces back together and screw grub screws through the hollow bar into the holes that you drilled. **Make sure you do not over tighten the grub screws.** Then place the tonneau sheath over the bar to stop the bar wearing against the tonneau. Refit the bar. You may kink the bar in the middle to give it some extra height to assist with water runoff.

Warning if you do not fit the tonneau sheath over the bar, the tonneau cover will quickly wear through which is not covered by warranty.

4. WARRANTY AND FEEDBACK

Please register your warranty details online at:

QR Code:



Website Link:

<http://www.tto.com.au/en-au/warranty.html>

Please complete our 2 minute feedback section as we strive to constantly improve for our customers.